



**DENVER
HEALTH™**
— est. 1860 —

HUDDLE SHEET

Ending a Dexcom G6 Sensor Session

When to end a sensor session:

- To change expired sensor
- If no longer needed (e.g. patient discharging) can end 10-day session early
- If system prompts a sensor change (e.g. sensor failure)

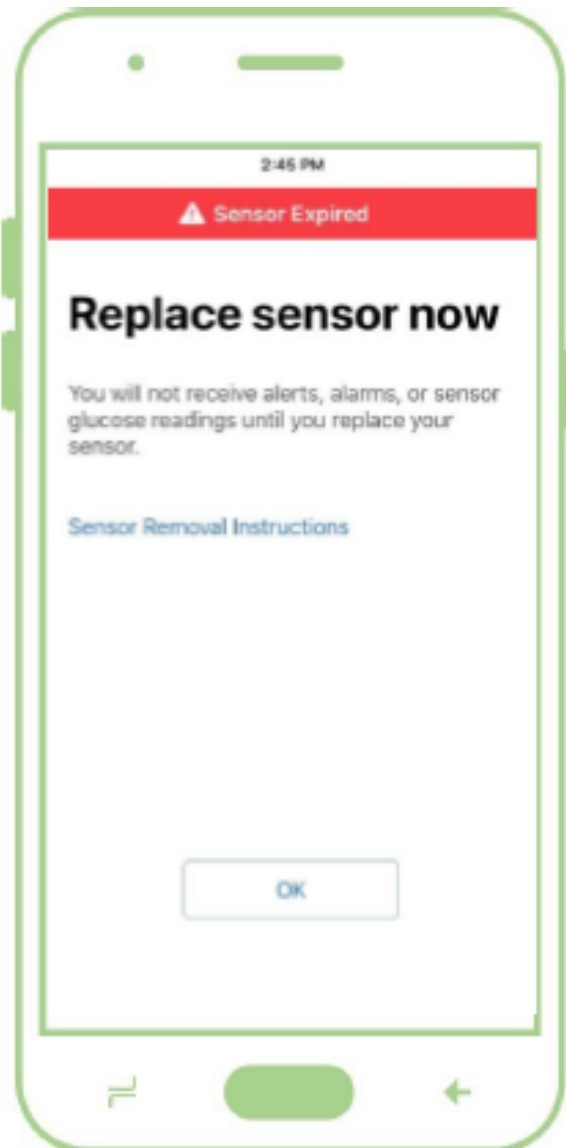

- The patient sensor automatically shuts off after 10 days
- The app alerts the patient at 6 hours, 2 hours, and 30 minutes before the sensor session ends
- To end a sensor sessions early, go to **Settings** and tap **Stop Sensor**